

3 SCSI setup

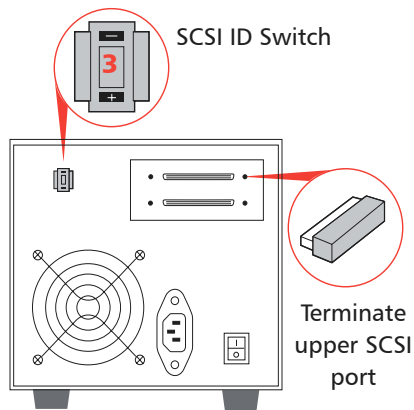

- a** If the Super DLTtape drive will be the only device connected to the SCSI bus, attach the enclosed terminator to the upper SCSI connector on the back of the drive.

The SCSI bus must be terminated at each end. The controller provides termination at one end, and the last device connected to the bus must be terminated to complete the SCSI chain.

- b** If you are inserting the drive into a SCSI daisy chain, ensure that the last device in the chain is terminated properly.
- c** Each device (external or internal) attached to the SCSI bus must have a unique SCSI ID. If necessary, change the SCSI ID of the Super DLTtape drive using the SCSI ID switch on the back of the drive.

Do not use SCSI ID 7. It is typically used by the SCSI card.

➔ User Reference Guide: **C3**

4 Connect the drive

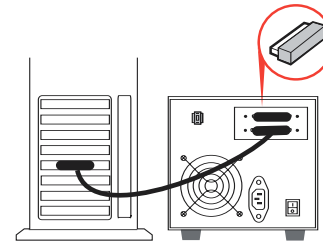

Cabling for Single Drive

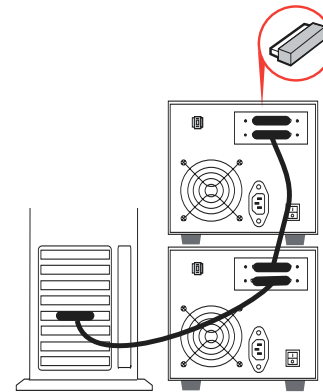

Cabling for Daisy Chain

- a** Before connecting the Super DLTtape drive, make sure the drive and computer are turned off.
- b** If you are daisy-chaining the drive, use the lower SCSI connector to connect to the host computer, and the upper to connect to additional devices.

If you plan to connect several devices to the SCSI bus, first connect only the Super DLTtape drive to the host computer. This will confirm that the drive is communicating properly with the host before adding additional devices.

- c** Connect the Super DLTtape drive to the host computer using the SCSI cable.

Check connections and ensure that they are attached correctly and firmly seated.

➔ User Reference Guide: **C4, C5**

